

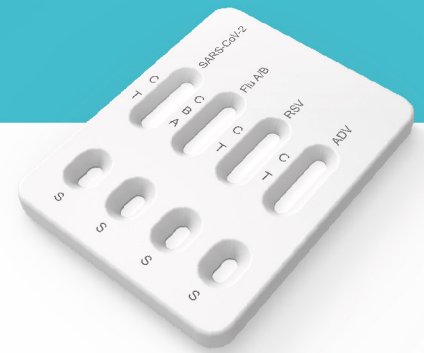

SARS-CoV-2 & Flu A/B & RSV & Adenovirus

Antigen Combo Rapid Test



Comprehensive **5 in 1**

A rapid, highly reliable and affordable kit, providing an aid in early diagnosis of individuals who are suspected of SARS-CoV-2 or Flu A/B or RSV or adenovirus infection by their healthcare provider and who are asymptomatic.

World Leader in Rapid Test Industry



Fast



Reliable



Easy to Use



User friendly



CE Marked



ACON Biotech (Hangzhou) Co., Ltd.

Flowflex SARS-CoV-2 & Flu A/B & RSV & Adenovirus Antigen Combo Rapid Test

The SARS-CoV-2 & Flu A/B & RSV & Adenovirus Antigen Combo Rapid Test is a lateral flow chromatographic immunoassay for the qualitative and differential detection of SARS-CoV-2, Influenza virus type A and type B nucleoprotein antigens (Flu A/B), RSV and respiratory adenovirus antigens in nasal swab or nasopharyngeal swab specimens directly from individuals who are suspected of SARS-CoV-2 or Flu A/B or RSV or adenovirus infection by their healthcare provider.

- **Nasal and Nasopharyngeal swab specimens**
- **Results at 15 min.**
- **Excellent performance compared to molecular methods**
- **Room temperature storage**

Clinical Performance

Nasal Swab Specimens

The performance of SARS-CoV-2 & Flu A/B & RSV & Adenovirus Antigen Combo Rapid Test was established with nasal swabs from a population of individuals. The results show that the relative sensitivity and the relative specificity are as follows:

Candidate method		RT-PCR		Total
		Negative	Positive	
SARS-CoV-2 Antigen Rapid Test	Negative	403	4	407
	Positive	2	99	101
	Total	405	103	508

Relative Sensitivity: 96.12% (90.12%-98.80%)*
Accuracy: 98.82% (97.38%-99.52%)*

Relative Specificity: 99.51% (98.10%-99.99%)*
*95% Confidence Intervals

Candidate method		Comparator		Total
		Negative	Positive	
Flu A Test Results	Negative	461	0	461
	Positive	2	45	47
	Total	463	45	508

Relative Sensitivity: 100.00% (90.62%-100.00%)*
Accuracy: 99.61% (98.48%-99.99%)*

Relative Specificity: 99.57% (98.33%-99.99%)*
*95% Confidence Intervals

Candidate method		Comparator		Total
		Negative	Positive	
Flu B Test Results	Negative	457	1	458
	Positive	2	48	50
	Total	459	49	508

Relative Sensitivity: 97.96% (88.31%-99.99%)*
Accuracy: 99.41% (98.19%-99.88%)*

Relative Specificity: 99.56% (98.32%-99.99%)*
*95% Confidence Intervals

Candidate method		Comparator		Total
		Negative	Positive	
RSV Test Results	Negative	470	0	470
	Positive	3	35	38
	Total	473	35	508

Relative Sensitivity: 100.00% (88.24%-100.00%)*
Accuracy: 99.41% (98.19%-99.88%)*

Relative Specificity: 99.37% (98.06%-99.88%)*
*95% Confidence Intervals

Candidate method		Comparator		Total
		Negative	Positive	
Adenovirus Test Results	Negative	465	1	466
	Positive	3	39	42
	Total	468	40	508

Relative Sensitivity: 97.50% (85.96%-99.99%)*
Accuracy: 99.21% (97.92%-99.77%)*

Relative Specificity: 99.36% (98.04%-99.87%)*
*95% Confidence Intervals

Nasopharyngeal Swab Specimens

The performance of SARS-CoV-2 & Flu A/B & RSV & Adenovirus Antigen Combo Rapid Test was established with nasopharyngeal swabs from a population of individuals. The results show that the relative sensitivity and the relative specificity are as follows:

Candidate method		RT-PCR		Total
		Negative	Positive	
SARS-CoV-2 Antigen Rapid Test	Negative	401	4	405
	Positive	2	97	99
	Total	403	101	504

Relative Sensitivity: 96.04% (89.93%-98.77%)*
Accuracy: 98.81% (97.36%-99.52%)*

Relative Specificity: 99.50% (98.09%-99.99%)*
*95% Confidence Intervals

Candidate method		Comparator		Total
		Negative	Positive	
Flu A Test Results	Negative	471	0	471
	Positive	3	30	33
	Total	474	30	504

Relative Sensitivity: 100.00% (86.53%-100.00%)*
Accuracy: 99.40% (98.18%-99.88%)*

Relative Specificity: 99.37% (98.07%-99.88%)*
*95% Confidence Intervals

Candidate method		Comparator		Total
		Negative	Positive	
Flu B Test Results	Negative	471	1	472
	Positive	2	30	32
	Total	473	31	504

Relative Sensitivity: 96.77% (82.42%-99.99%)*
Accuracy: 99.40% (98.18%-99.88%)*

Relative Specificity: 99.58% (98.37%-99.99%)*
*95% Confidence Intervals

Candidate method		Comparator		Total
		Negative	Positive	
RSV Test Results	Negative	471	0	471
	Positive	3	30	33
	Total	474	30	504

Relative Sensitivity: 100.00% (86.53%-100.00%)*
Accuracy: 99.40% (98.18%-99.88%)*

Relative Specificity: 99.37% (98.07%-99.88%)*
*95% Confidence Intervals

Candidate method		Comparator		Total
		Negative	Positive	
Adenovirus Test Results	Negative	469	1	470
	Positive	3	31	34
	Total	472	32	504

Relative Sensitivity: 96.88% (82.89%-99.99%)*
Accuracy: 99.21% (97.90%-99.77%)*

Relative Specificity: 99.36% (98.06%-99.87%)*
*95% Confidence Intervals

Materials Provided

- Test Cassettes
- Extraction Buffer Tubes
- Nasal Swabs or Nasopharyngeal Swabs
- Package Insert
- Specimen Collection Guide

Specimen Collection

Nasal Swabs

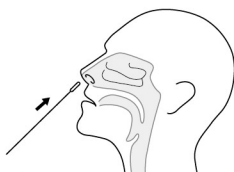

1 Using gentle rotation, insert the swab into the nostril to less than 2.5 cm (1 inch) from the edge of the nostril.

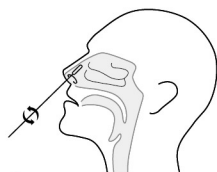

2 Rotate the swab 5 times against the mucosa inside the nostril.



3 Using the same swab, repeat this process in the other nostril.

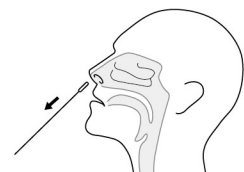

4 Withdraw the swab from the nasal cavity. The sample is now ready for preparation.

Nasopharyngeal Swabs

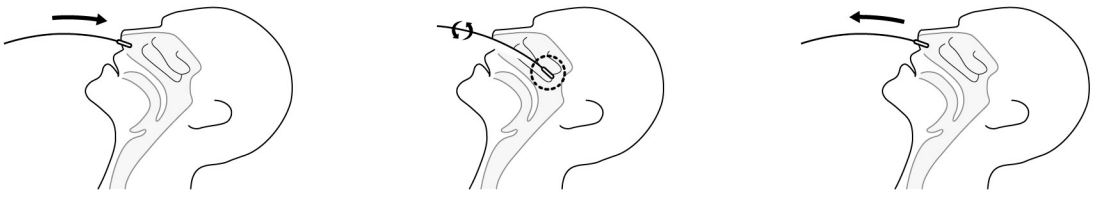
- 
- 1 Tilt patient's head back 70 degrees. Gently and slowly insert a nasopharyngeal swab, through the nostril parallel to the palate until resistance is encountered.
 - 2 Gently rub and roll the swab, leaving it in place for several seconds to absorb secretions.
 - 3 Slowly remove swab while rotating it. The specimen is now ready for preparation using the extraction buffer tubes.

Test Procedure and Interpretation

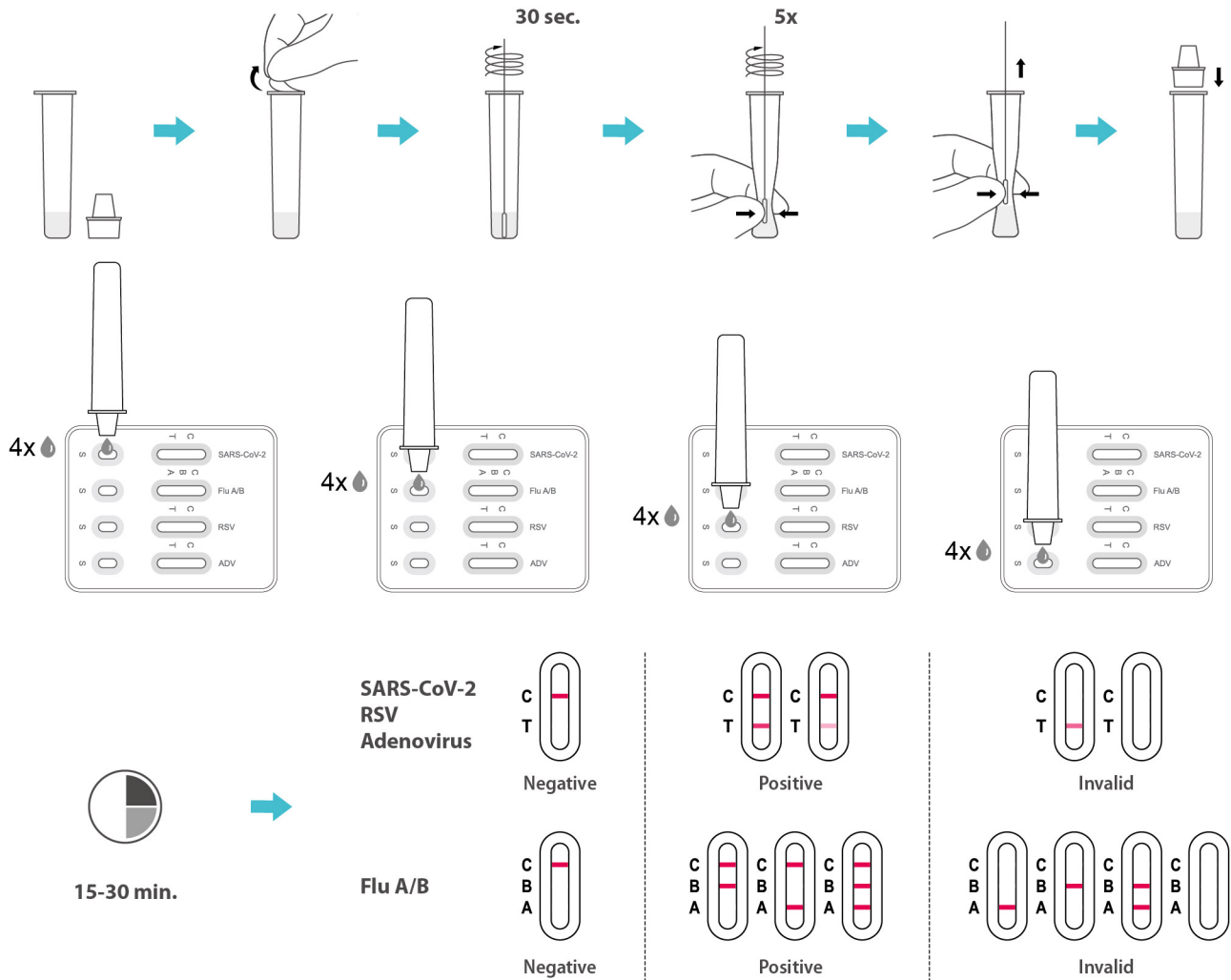

Ordering Information

Product Name	Catalog No.	Format	Specimen	Package
Flowflex SARS-CoV-2 & Flu A/B & RSV & Adenovirus Antigen Combo Rapid Test	L031-12335 ✓	Cassette	Nasal and Nasopharyngeal swabs	20 Tests/Kit

✓ CE marked



www.aconbio.com

ACON Biotech (Hangzhou) Co., Ltd.
 No.210 Zhenzhong Road, West Lake District,
 Hangzhou, P.R.China, 310030
 Tel: +86-571-8118 9706
 Email: information@aconlab.com.cn