

FlowFlex COVID-19 Rapid Antigen Nasal Lateral Flow Test Kits - Single Kits

- Non-Invasive Swab only 1-2cm into the lower nostril completely reduces discomfort
- Results in 15 minutes offer significant time/cost savings over lab methods & accuracy of up to 98.8%
- Supplied with pre-filled tubes of buffer fluid for maximum ease of use
- CE Certified and MHRA Registered



TEST PROCEDURE

COLLECTION BY AN
ADULT CAREGIVER

OR

SELF COLLECTION

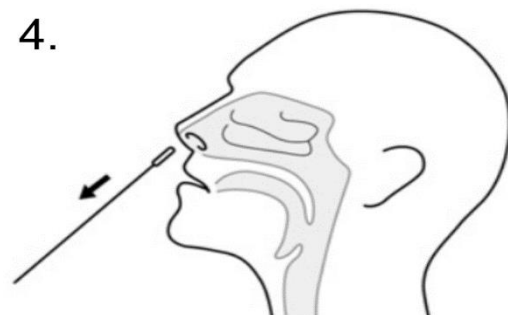
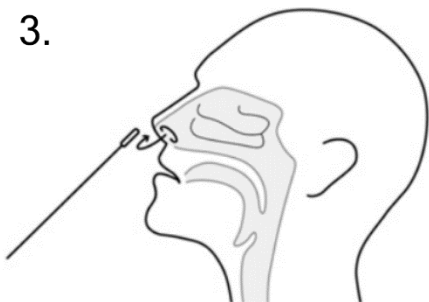
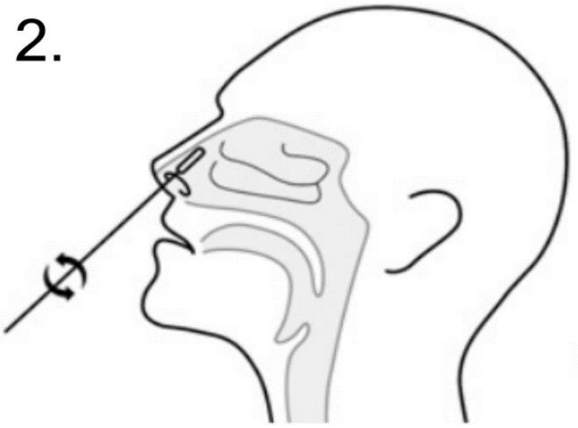
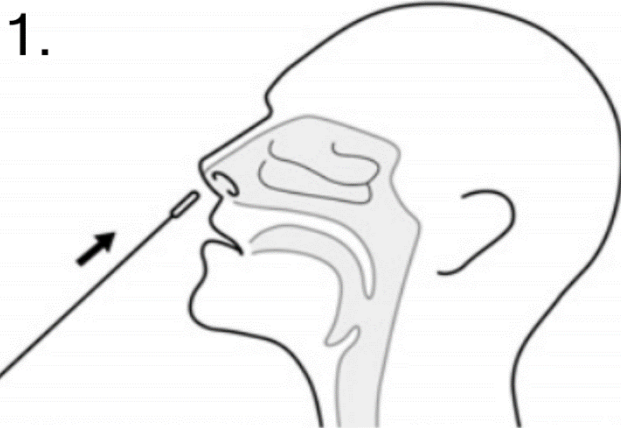

1. Insert the entire absorbent tip of the swab into one nostril. Using gentle rotation, push the swab less than 2.5 cm from the edge of the nostril.

2. Rotate the swab 5 times brushing against the inside of the nostril.

3. Remove the swab and insert it into the other nostril. Repeat step 1.

4. Remove swab from the nostril.

SAMPLE PREPARATION

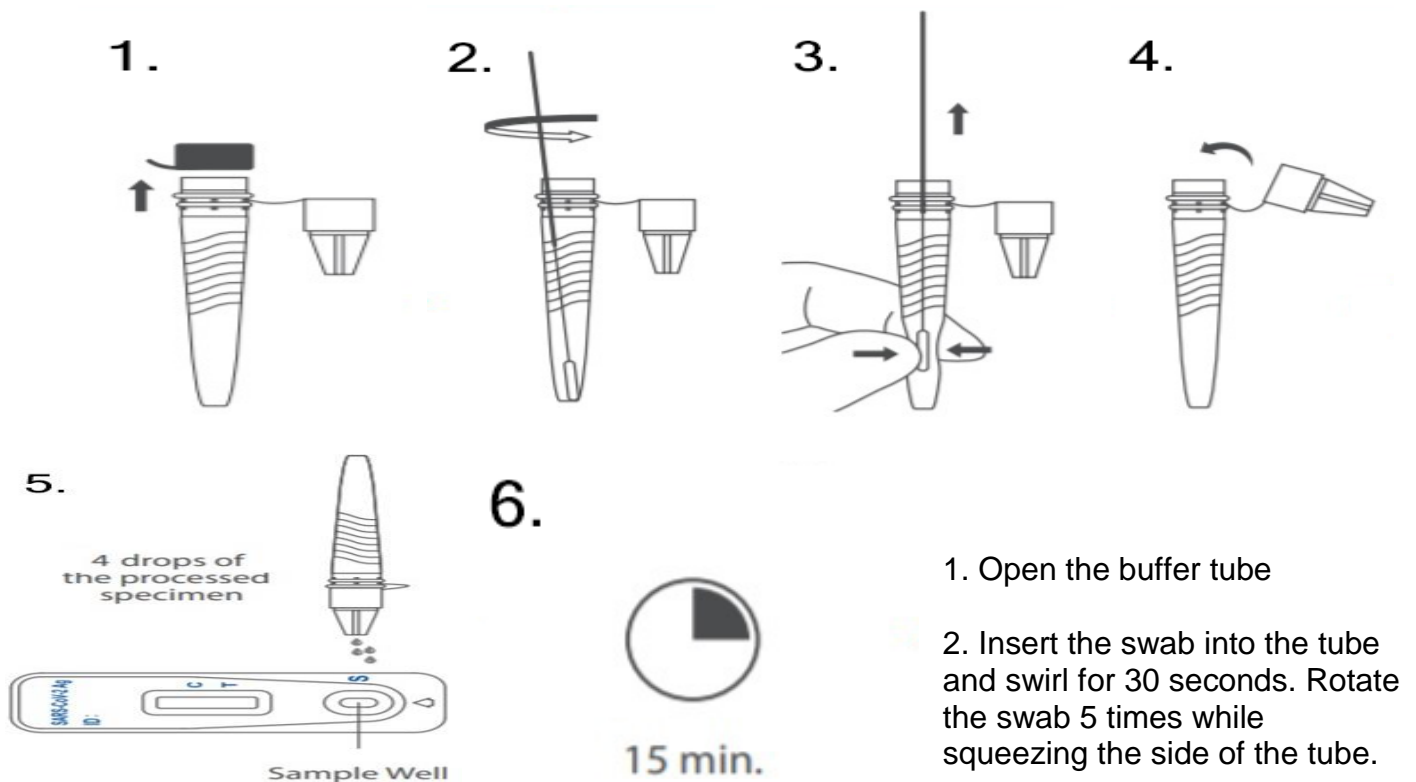

3. Remove the swab while squeezing the tube.

4. Attach the dropper tip firmly onto the extraction buffer tube. Mix thoroughly by swirling or flicking the bottom of the tube.

5. Gently squeeze the tube and dispense 4 drops of the processed specimen into the sample well.

6. Read the result when the timer reaches 15 minutes. Do not read after 30 minutes.

INTERPRETATION OF THE RESULTS

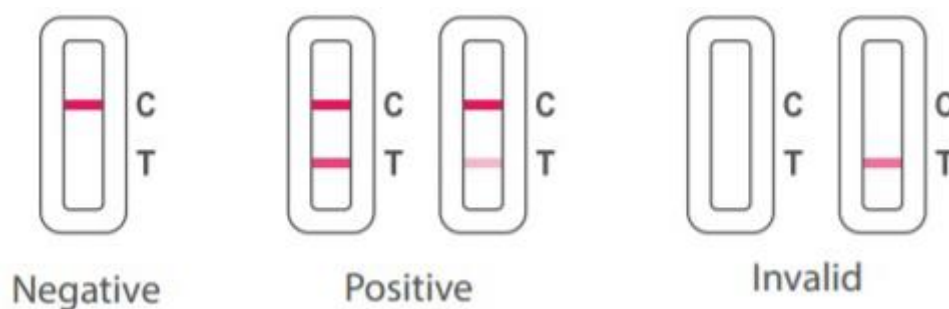

Once 15 minutes has passed check the results indicator

The "C" (control) line must have a red mark or the test is invalid

The "T" (test) line is red for a positive result (even a faint line is a positive result)

PRODUCT DETAILS & SPECIFICATIONS

These Flowflex COVID-19 Rapid Antigen Lateral Flow Test Kits use the latest patented technology in detecting proteins ensuring that it can detect new strains of the COVID-19 virus. They are fully

approved by UK Government Public Health England, Porton Down Laboratory for Home Use, are very quick and simple to administer, and offer a combined testing **accuracy of up to 98.8%** to find out if you currently have COVID-19 in just 15 minutes.

These lateral flow tests kits are packed individually (**boxes of 20 are also available**).

They differ from your usual nasopharyngeal lateral flow COVID-19 test as the test only needs to enter the lower nostril, therefore, reducing discomfort without compromising on accuracy. The test only requires a 1-2cm swab, unlike the standard 9-10cm swab into the nostril.

The test kits are uniquely packaged with their own individual serial number for mass testing and tracing to ensure easy distribution and to eliminate the risk of contamination to your workforce. The tests are suitable for testing large groups of people, including regular testing of employees in education, healthcare, sports, commercial, retail, travel, and care industries.

Clinical trials from various countries show a combined accuracy of 98.8% (97.1% relative sensitivity and 99.5% relative specificity) for these tests.

Each individual test kit includes:

- 1 x Individually sealed test cassette
- 1 x Individually sealed disposable swab (1-2cm into the lower nostril)
- 1 x Pre-filled extraction buffer tube
- 1 x Instructions
- 1 x Waste Bag

The results will inform you of the following, although please be aware that if the C line does not appear, the test is invalid. There is 1 negative and 1 positive result:

Negative Result: If only the quality control line (C) appears and the detection line (T) is not visible, then no SARS-CoV-2 antigen has been detected and the result is negative.

Positive Result: C and T - if the quality control line (C) and the detection line (T) appears, then the SARS-CoV-2 antigen has been detected and the result is positive.

These FlowFlex Rapid Lateral Flow Antigen Test Kits are MHRA registered, CE Marked, and ISO certified.